

Visual Artisan Floors

SILENQ ACOUSTIC Wall Panels

Not suitable for areas exposed to moisture, humidity, or direct water contact.

Wall Panel Installation Guide

Before You Start

- Panels are intended for **interior, dry, climate-controlled environments only**
- Wall surface must be **clean, dry, smooth, and structurally sound**
- Installer must inspect panels **before installation**

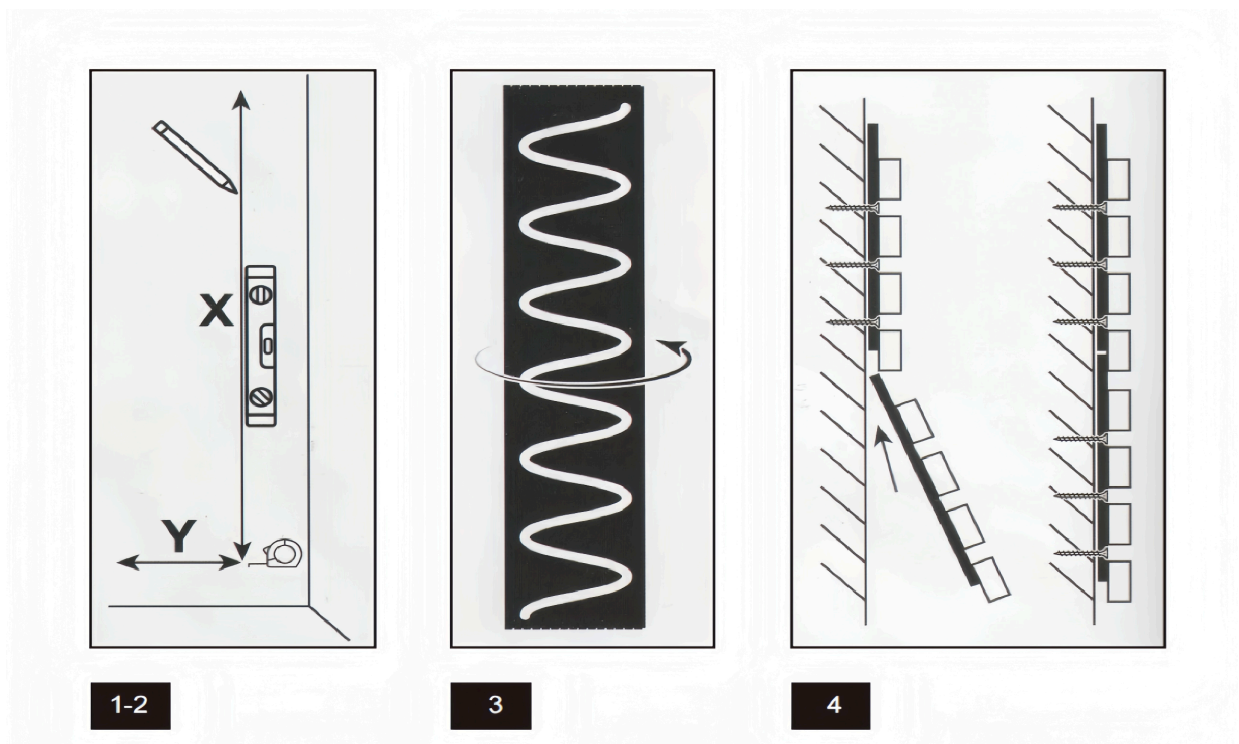

Step-by-Step Installation

1. Wall Preparation

Visual Artisan Floors

Clean the wall thoroughly before installation.

- Remove dust, oil, grease, and debris using a damp cloth or mild detergent
- Ensure the wall surface is **dry, flat, and smooth**
- Uneven or contaminated surfaces may reduce adhesive performance

Proper surface preparation is critical to ensure long-term adhesion.

2. Measuring & Cutting Panels

Measure the installation area carefully.

- Mark panel dimensions based on wall height and layout
- Use appropriate cutting tools (utility knife, fine-tooth saw, or cutter)
- Cut panels to the required size and shape before applying adhesive

Dry-fit panels prior to installation to confirm alignment and layout.

3. Adhesive Application & Panel Installation

Attach the panels using approved construction adhesive.

- Apply adhesive in a **continuous “S” or zig-zag pattern** to the back of the panel
- Press the panel firmly onto the wall, starting from one side
- Use a scraper or roller to remove air pockets and ensure full contact
- Panels must sit **flat and flush** against the wall surface

Avoid spot-gluing. Full adhesive coverage improves bond strength and stability.

Visual Artisan Floors

4. Mechanical Reinforcement (Recommended)

For added stability, especially on large panels or uneven walls:

- Secure panels with **screws or fasteners into wall studs**
- Fasteners should be evenly spaced and properly seated
- Conceal fasteners where possible for a clean finish

Mechanical reinforcement is recommended but does not replace proper adhesive installation.

Tools & Materials Required

- Measuring tape & level
 - Pencil or marker
 - Cutting tool (utility knife or saw)
 - Approved construction adhesive
 - Scraper or roller
 - Screws & drill (if reinforcing)
-

Installer Responsibility Notice

Installer is responsible for:

Visual Artisan Floors

- Verifying site conditions
- Ensuring proper installation methods
- Compliance with local building codes

Improper installation or unsuitable site conditions may void the warranty.